

TREE REMOVAL SCHEDULE *			
DIAMETER	TYPE	QUANTITY IN R/W	QUANTITY OUTSIDE R/W INSIDE TMP AREA
2"-12"	CONIFEROUS	10	2
2"-12"	DECIDUOUS	18	8
13"-24"	DECIDUOUS	7	7
25"-36"	DECIDUOUS	4	1
37"-60"	DECIDUOUS	2	0
OVER 60"	DECIDUOUS	0	0
STUMP	DECIDUOUS	3	4

\*CHART ABOVE DOES NOT INCLUDE ALL TREES, STUMPS AND BRUSH REMOVAL REQUIRED FOR THE PROJECT. THE COST FOR ALL TREE, STUMP AND BRUSH REMOVAL, WHETHER SHOWN OR NOT SHOWN ON THE PLANS, SHALL BE INCLUDED IN THE LUMP SUM PRICE BID FOR ITEM 201 - CLEARING AND GRUBBING, AS PER PLAN. THE CITY INTENDS TO CLEAR SOME TREES SHOWN ON THESE PLANS IN ADVANCE OF THE PROJECT SALE DATE. THE CONTRACTOR SHALL VISIT THE PROJECT SITE TO VERIFY THE FIELD CONDITIONS PRIOR TO SUBMITTING A BID.

CITY OF HUDSON  
ENGINEERING DEPARTMENT  
1140 TEREX ROAD  
HUDSON, OH 44236  
(330)-342-1770

INGLESIDE DR.

DESCRIPTION:										
REV. #										
DATE:										

TREE CLEARING PLAN

CALCULATED	XXX
CHECKED	XXX

SHEET 27 OF 69



S:\CAPITAL PROJECTS\000T PROJECTS\Ingleside Drive Bridge (107018)\CAD Drawings\TREE DRAWING.dwg, 9/4/2020 10:17:14 AM, DWG To PDF.pc3

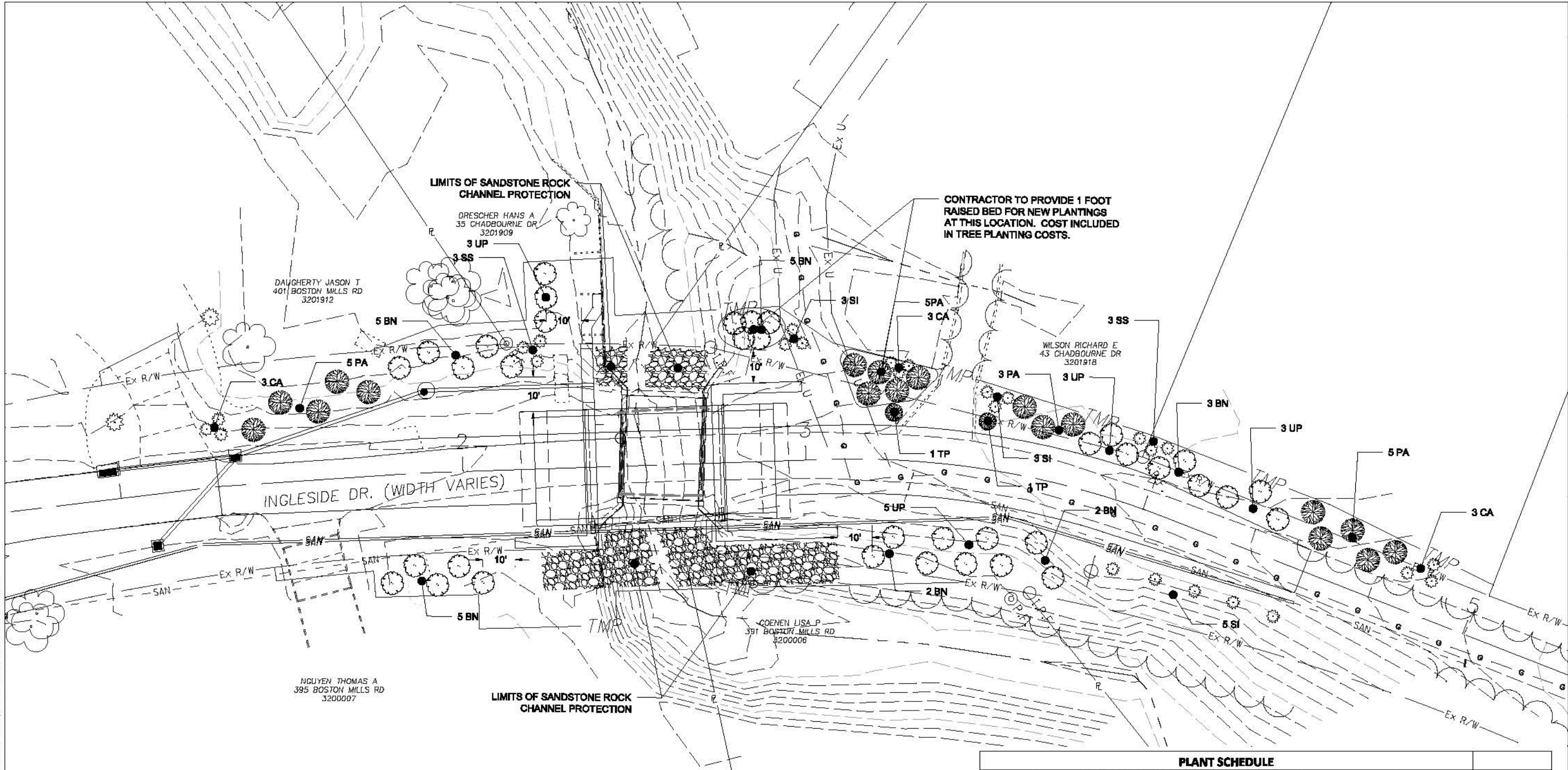

NOTES:

1. PRIOR TO FINAL PLANTING, THE CONTRACTOR SHALL STAKE AND/OR PLACE PLANTINGS (PRIOR TO INSTALLATION) IN THE FIELD FOR FINAL REVIEW BY CITY OF HUDSON. THE CITY RESERVES THE RIGHT TO RELOCATE TREES TO BETTER MEET FIELD CONDITIONS AS DETERMINED BY THE CITY ARBORIST AND/OR CITY ENGINEER.
2. CONTRACTOR TO VERIFY CONDITIONS AND DIMENSIONS IN THE FIELD AND NOTIFY THE CITY OF HUDSON OF DISCREPANCIES.
3. CONTRACTOR IS RESPONSIBLE FOR PROVIDING PLANT QUANTITIES DETAILED ON PLAN. THE SCHEDULE IS PROVIDED FOR SUMMARY ONLY.
4. PROVIDE A MINIMUM 3-FOOT DIAMETER MULCH BED AROUND EACH INDIVIDUAL TREE UNLESS THEY ARE INCORPORATED INTO A PLANTING BED.
5. ANY PLANT MATERIAL SUBSTITUTIONS SHALL BE REVIEWED/APPROVED BY THE CITY OF HUDSON PRIOR TO PURCHASE AND DELIVERY TO SITE.
6. APPROVED SUBSTITUTE TREE SPECIES FOR THE DYNASTY ELM WILL BE ULMUS FRONTIER (FRONTIER ELM)

PLANT SCHEDULE					
KEY	QTY	BOTANICAL / COMMON NAME	SIZE	CONDITION	SPACING
		Deciduous Trees			
BN	22	Betula nigra / River Birch "Heritage" - Single Stem	2 Inch - 3 Inch	B&B	See Plan
UP	14	Ulmus Prvifolia / Dynasty Elm	2.5 Inch - 3 Inch	B&B	See Plan
	36	=Total Deciduous Tree Plantings			
		Coniferous Trees			
TP	2	Thuja plicata / Green Giant Arborvitae	6 Foot to 8 Foot	B&B	See Plan
PA	18	Picea Abies / Norway Spruce	8 Foot to 10 Foot	B&B	See Plan
	20	=Total Coniferous Tree Plantings			
		Bushes			
SI	8	Salix Integra 'Hakuro Nishiki' / Dappled Willow	18 Inch to 24 inch	3 gallon	See Plan
SS	6	Salix sandbar / Sandbox Willow	18 Inch to 24 Inch	3 gallon	See Plan
CA	9	Cornus Alba / Red twig Dogwood	18 Inch to 24 Inch	3 gallon	See Plan
	23	=Total Bush Plantings			

OHIO  
**HUDSON**

30  
15  
0

SCALE IN FEET

CITY OF HUDSON  
ENGINEERING DEPARTMENT  
1140 TEREX ROAD  
HUDSON, OH 44236  
(330)-342-1770

INGLESIDE DR.

DESCRIPTION:					
REV. #:					
DATE:					

TREE PLANTING PLAN

CALCULATED	XXX
CHECKED	XXX

SHEET 28 OF 69