

Phase 1 Fire Dorm, Fire and EMS Vestibules Fitness Room and Turnout Room along with K2M FCA "Immediate" Items

Phase 2 Office Moves to PD Side, Fire Day Room, Kitchen K2M FCA "Near-Term" and "Full-Reno" Items

Phase 3 EMS Dorms, Bathrooms, Lockers

Phase 4 EMS Day Room, Bathrooms, Offices

Phase 5 EMS Decon Room, Fire Decon Room and Rear Garage

PHASES

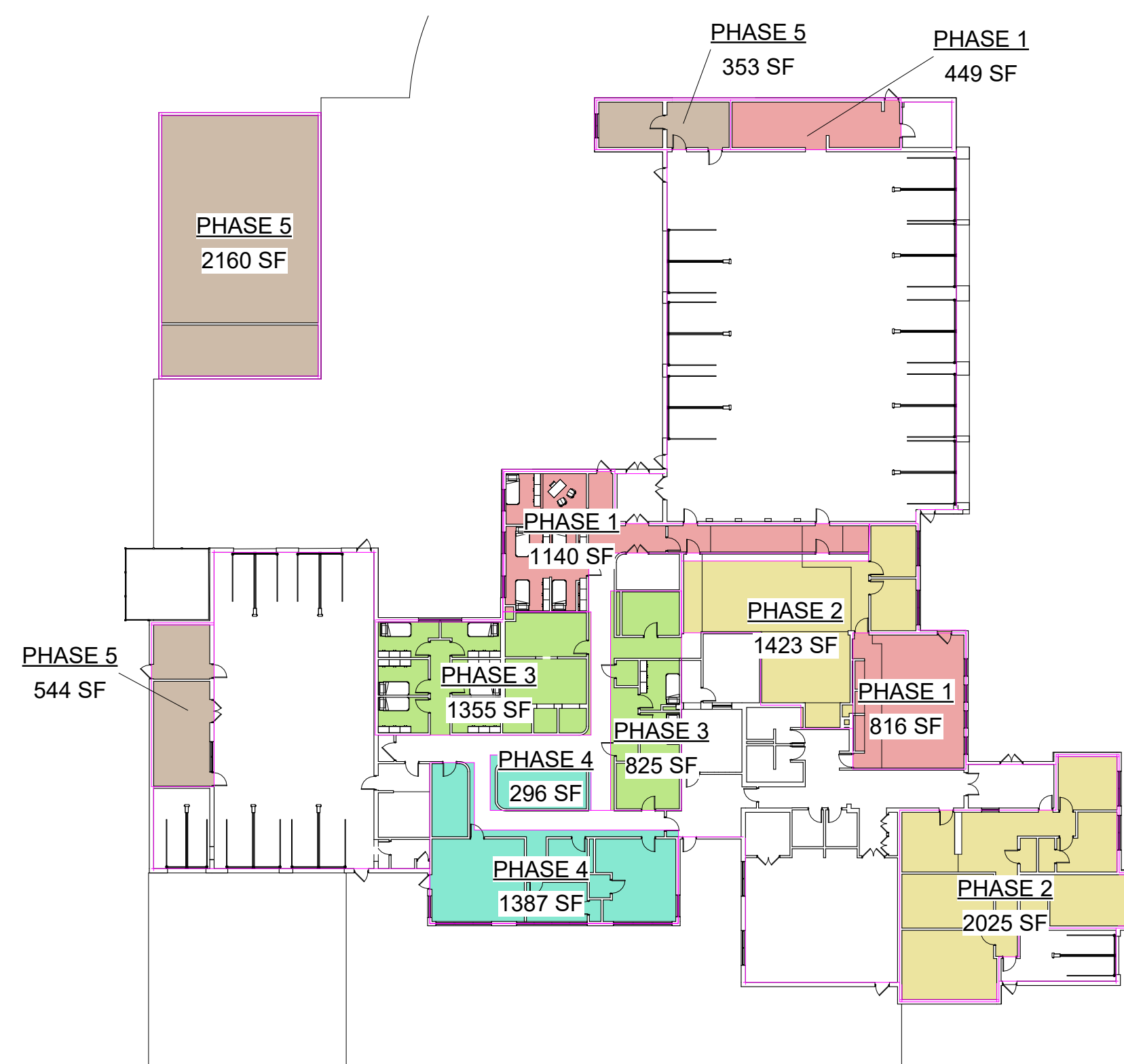

PHASE PLAN

Existing Hudson Fire & EMS - Phased Approach				
	Cost / SF	Project Cost		
		Low	Mid	High
Building Cost - Phase 1 and 2	\$ 150.00	\$ 175.00	\$ 200.00	
FF&E	\$ 877,950.00	\$ 1,024,275.00	\$ 1,170,000.00	
FCA Work	\$ 100,000.00	\$ 115,000.00	\$ 130,000.00	
Construction Cost	\$ 2,609,984.00	\$ 2,609,984.00	\$ 2,609,984.00	
Soft Costs	\$ 3,587,934.00	\$ 3,749,259.00	\$ 3,910,584.00	
Contingencies	15.0%	\$ 538,190.10	\$ 562,388.85	\$ 586,587.60
Escalation	4.5%	\$ 185,675.58	\$ 194,024.15	\$ 202,372.72
Insurance	1.0%	\$ 41,261.24	\$ 43,116.48	\$ 44,971.72
Builders Risk	0.2%	\$ 8,252.25	\$ 8,623.30	\$ 8,994.54
Construction Fee	0.0%	\$ 130,839.40	\$ 136,722.35	\$ 142,605.31
AE Fee	8.0%	\$ 344,943.97	\$ 360,453.76	\$ 375,963.55
Grand Total (Phase 1 and 2)	\$ 4,837,096.54	\$ 5,054,587.89	\$ 5,272,079.24	
Building Cost - Phase 3	2180	\$ 436,000.00	\$ 490,500.00	\$ 545,000.00
Building Cost - Phase 4	1387	\$ 277,400.00	\$ 312,975.00	\$ 348,750.00
Building Cost - Phase 5	3057	\$ 611,400.00	\$ 687,825.00	\$ 764,250.00
Grand Total All Phases		\$ 6,161,896.54	\$ 6,544,987.89	\$ 6,928,079.24

Phased Cost Estimate

Sheet Number	A2.1.1
Sheet Issue Date	02/18/25
K2M Project Number	24061