

2

RESTROOM BUILDING NORTH ELEVATION

SCALE: 3/8" = 1'-0"

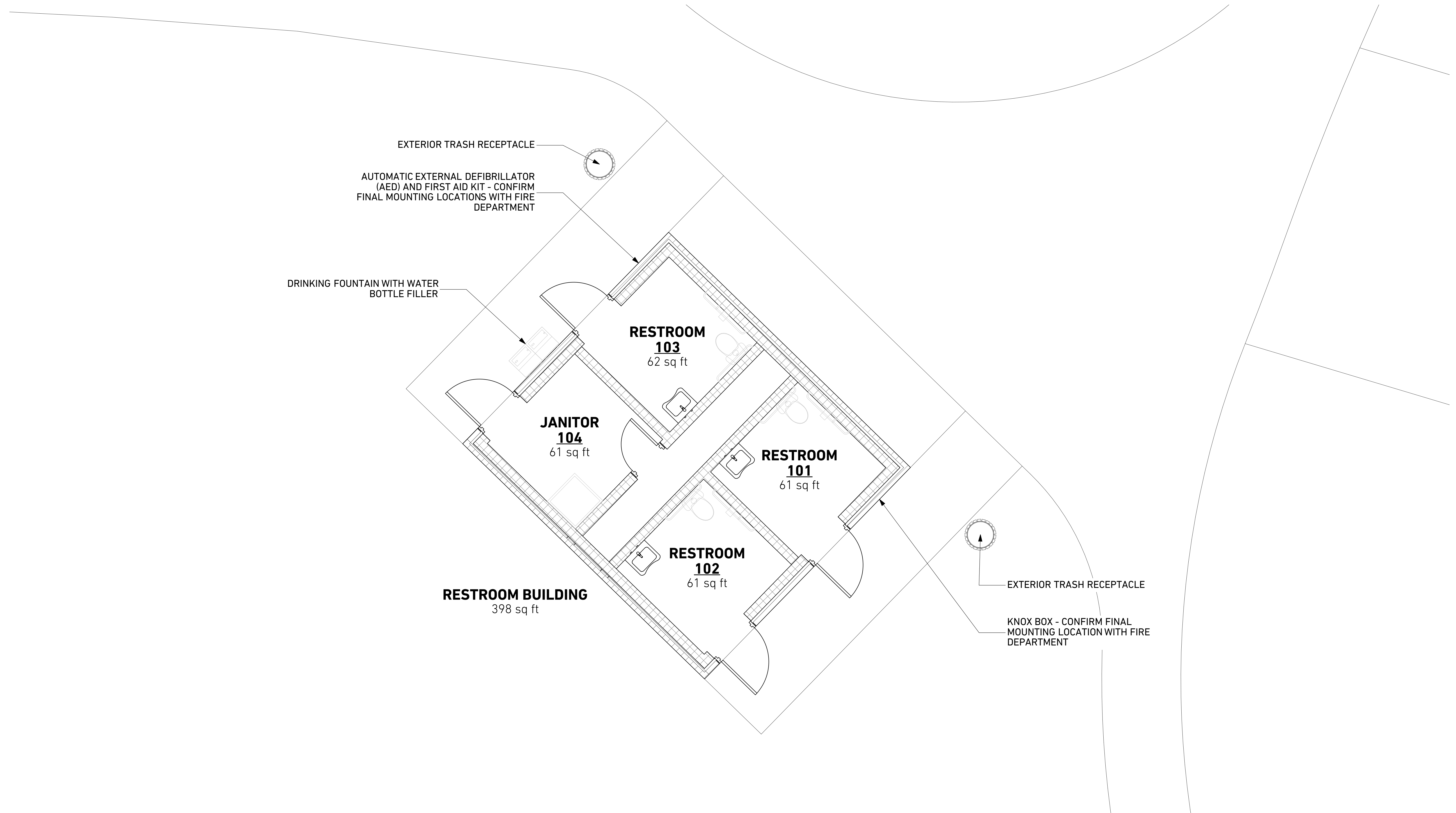

Restroom Building - 4.21.2025

Activity	Qty	Unit	Unit Cost	Cost
Concrete				
Footings	72	lf	\$ 150.00	\$ 10,800
Slab on Grade	380	sf	\$ 10.00	\$ 3,800
Frost Slabs	2	ea	\$ 2,500.00	\$ 5,000
Sidewalks	200	sf	\$ 12.00	\$ 2,400
Masonry				
Brick	960	sf	\$ 65.00	\$ 62,400
CMU Foundations and Walls	1,430	sf	\$ 20.00	\$ 28,600
Steel				
Misc Steel	1	ls	\$ 5,000.00	\$ 5,000
General Trades				
Carp Matl				
Blocking	1	ls	\$ 2,500.00	\$ 2,500
Roof Truss and Sheeeting	1	ls	\$ 10,000.00	\$ 10,000
Fasteners	1	ls	\$ 2,500.00	\$ 2,500
Carpentry Labor				
Roof Truss and Sheeeting	80	hrs	\$ 72.00	\$ 5,760
Common Labor				
Pick Up Matl / Equip/Deliveries	40	hr	\$ 65.00	\$ 2,600
Cont Interim	0	hr	\$ 65.00	\$ -
Dumpster				
Construction	4	ea	\$ 650.00	\$ 2,600
Demolition	0	ea	\$ 550.00	\$ -
Owner	0	ea	\$ 550.00	\$ -
Final Clean				
Punch List	1	ls	\$ 2,500.00	\$ 2,500
Temp Protection				
Floor Protection	0	sf	\$ 0.50	\$ -
Equipment				
Lift	1	mo	\$ 4,000.00	\$ 4,000
Millwork - Supply				
	0	sf	\$ 16.05	\$ -
	0	hrs	\$ 72.00	\$ -
Insulation				
Restroom Walls	1	ls	\$ 4,000.00	\$ 4,000
Roofing				
Shingle Roof	380	sf	\$ 15.00	\$ 5,700
Gutters and Downspouts	100	lf	\$ 30.00	\$ 3,000
D-F-H				
Supply - Exterior Aluminum Doors	4	ea	\$ 3,000.00	\$ 12,000
Access Doors	1	ls	\$ 500.00	\$ 500
Installation	40	hrs	\$ 72.00	\$ 2,880
Glass / Alum				
Framing / Drywall				
Ceilings				
ACT Clg	380	sf	\$ 6.00	\$ 2,280
Carpet / Resil / Tile / Wood Flooring				
Sealed Concrete	380	sf	\$ 3.00	\$ 1,140
Painting				
Restroom Walls	1,190	sf	\$ 2.00	\$ 2,380
Doors and Frames	5	ea	\$ 300.00	\$ 1,500
Janitor Ceiling	60	sf	\$ 2.00	\$ 120
Specialties				
Toilet Accessories	1	ls	\$ 4,000.00	\$ 4,000
Partitions	0	ls	\$ 6,000.00	\$ -
Installation	32	hrs	\$ 72.00	\$ 2,304
Fire Suppression				
New Fire Sprinkler System	0	sf	\$ 15.00	\$ -
Plumbing				
Restrooms	1	ls	\$ 50,000.00	\$ 50,000
HVAC				
Electric Heat	0	ls	\$ 5,000.00	\$ -
Electric				
Electrical	1	sf	\$ 15,000.00	\$ 15,000

Category \$
\$ 14,600
\$ 91,000
\$ 5,000
\$ 32,460
\$ -
\$ 4,000
\$ 8,700
\$ 15,380
\$ -
\$ -
\$ 2,280
\$ 1,140
\$ 4,000
\$ 6,304
\$ -
\$ 50,000
\$ -
\$ 15,000
\$ 249,864
\$ (505,874)

Restroom Only Building \$ 249,864

SAVINGS FROM SD Budget \$ (505,874)